

# Trace Diagram

Job No. 2001-003

## Seismic Line *PC*

Client: Great South Lands Minerals Limited

Project: 2001 Northern Midlands Seismic Survey

Seismic Contractors: Trace Energy Services Pty. Ltd.

Stn Interval 25 m  
Shooting Direction

From STN 1410 To STN 1491  
West to East 1 South to North

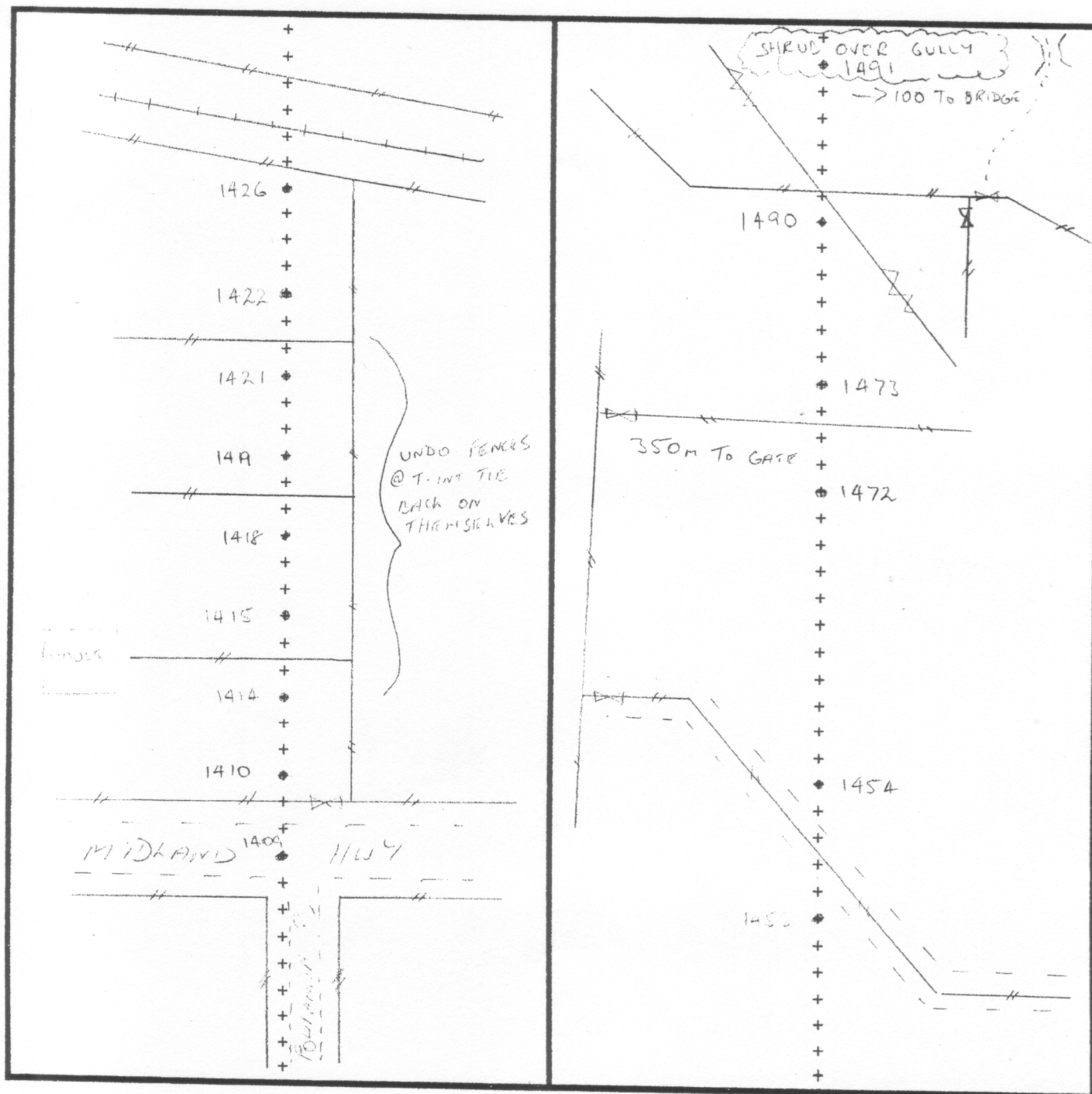

**Wilson Survey Group P/L**

Exploration, Mining and Engineering Surveyors  
Specialising in Real Time GPS Applications

Page...1...of Pages...2...

# Trace Diagram

Job No. 2001-003

Seismic Line PG.

Client: Great South Lands Minerals Limited

Project: 2001 Northern Midlands Seismic Survey

Seismic Contractors: Trace Energy Services Pty. Ltd.

Stn Interval 25 m  
Shooting Direction

From STN 1491 To STN 1506  
West to East 1/1 South to North

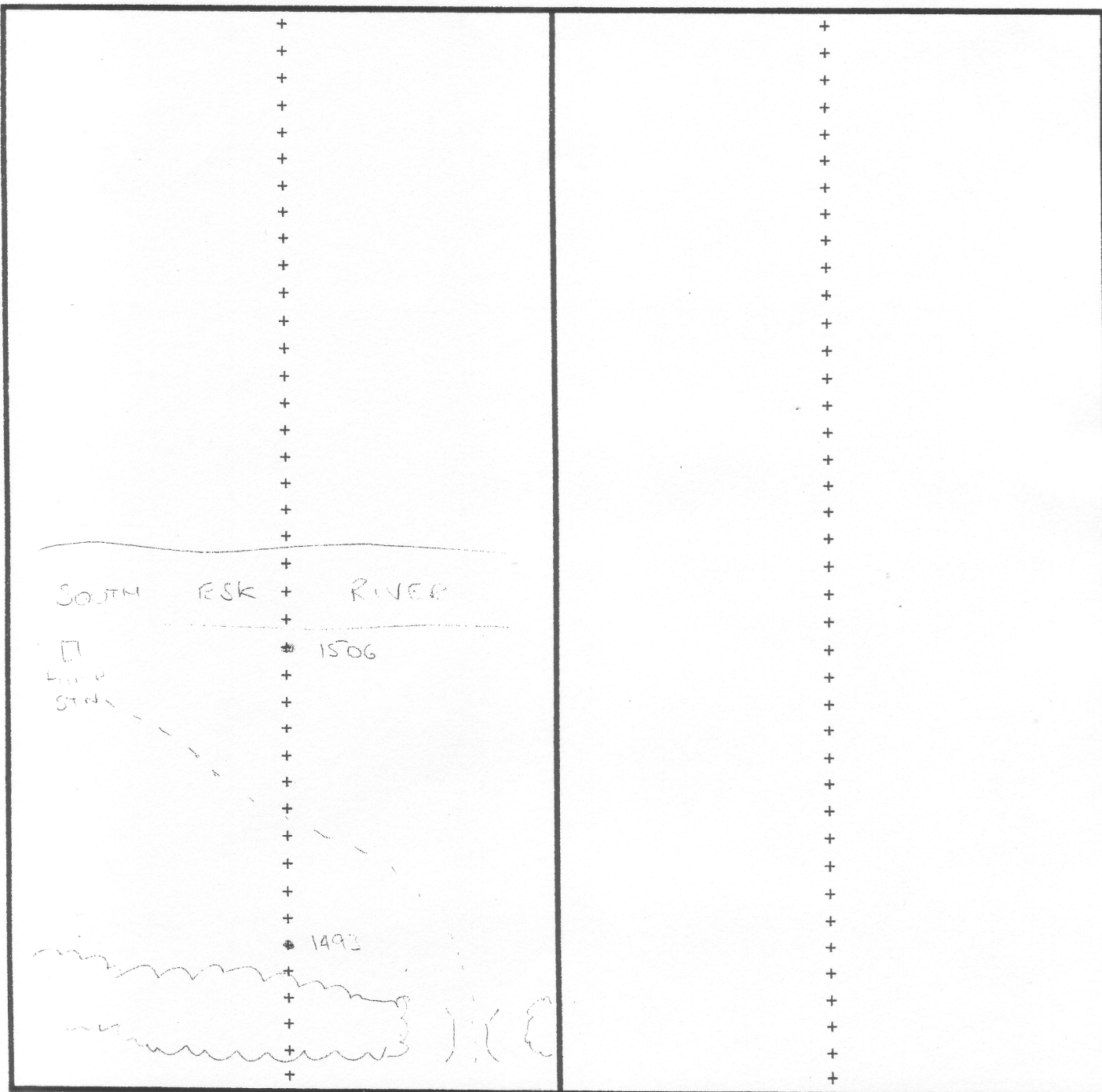

**Wilson Survey Group P/L**

Exploration, Mining and Engineering Surveyors  
Specialising in Real Time GPS Applications

Page 2 of Pages 2

# Trace Diagram

Job No. 2001-003

## Seismic Line PG

Client: Great South Lands Minerals Limited  
Project: 2001 Northern Midlands Seismic Survey  
Seismic Contractors: Trace Energy Services Pty. Ltd.

Stn Interval 25 m  
 Shooting Direction

From STN 1507 To STN 1645  
 West to East / South to North

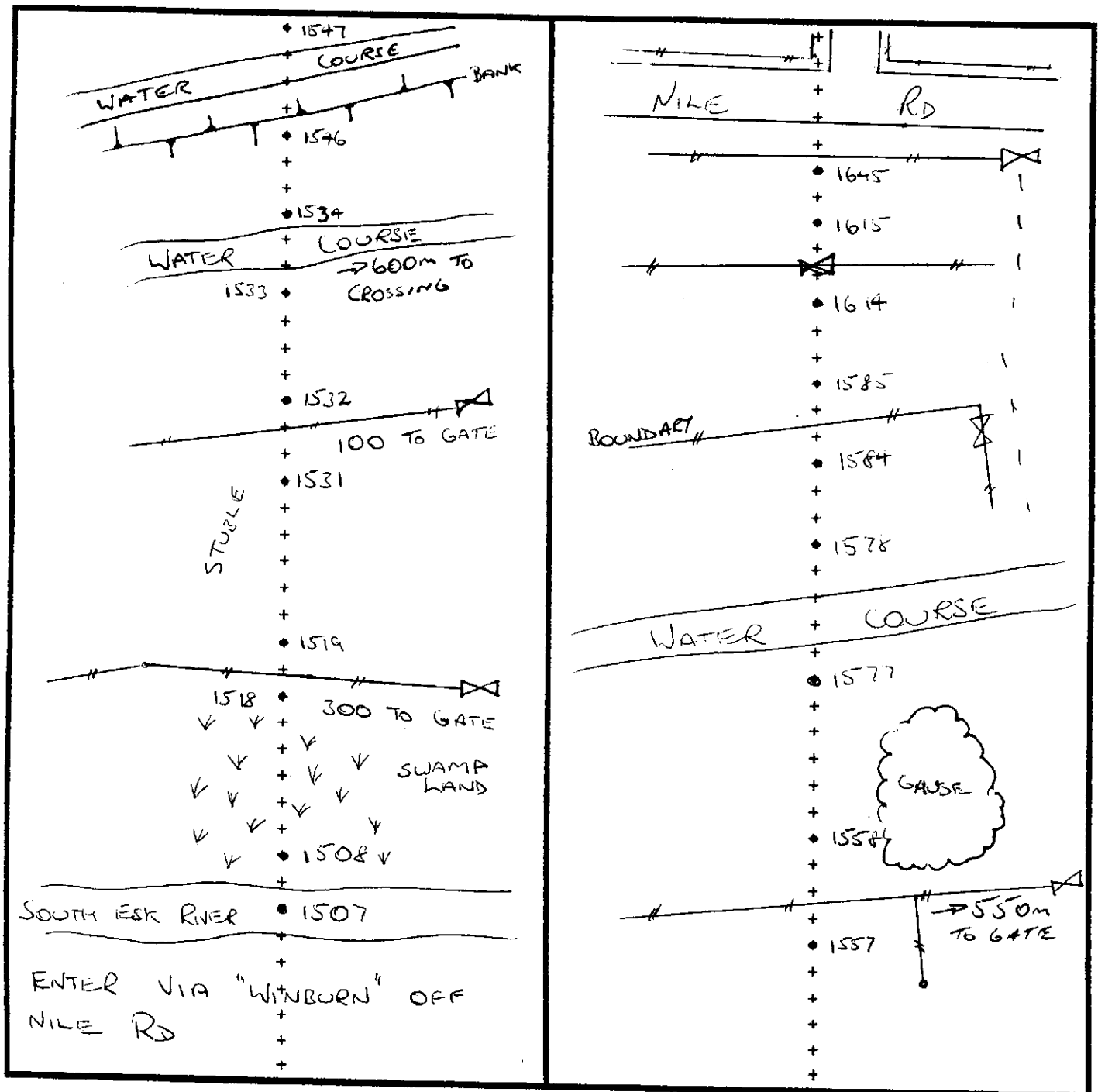

Wilson Survey Group P/L

Exploration, Mining and Engineering Surveyors  
 Specialising in Real Time GPS Applications

Page...!...of Pages.....

# Trace Diagram

Job No. 2001-003

Seismic Line PG

Client: Great South Lands Minerals Limited

Project: 2001 Northern Midlands Seismic Survey

Seismic Contractors: Trace Energy Services Pty. Ltd.

Stn Interval 25 m  
Shooting Direction

From STN 1646 To STN 1728  
West to East / ~~East to West~~

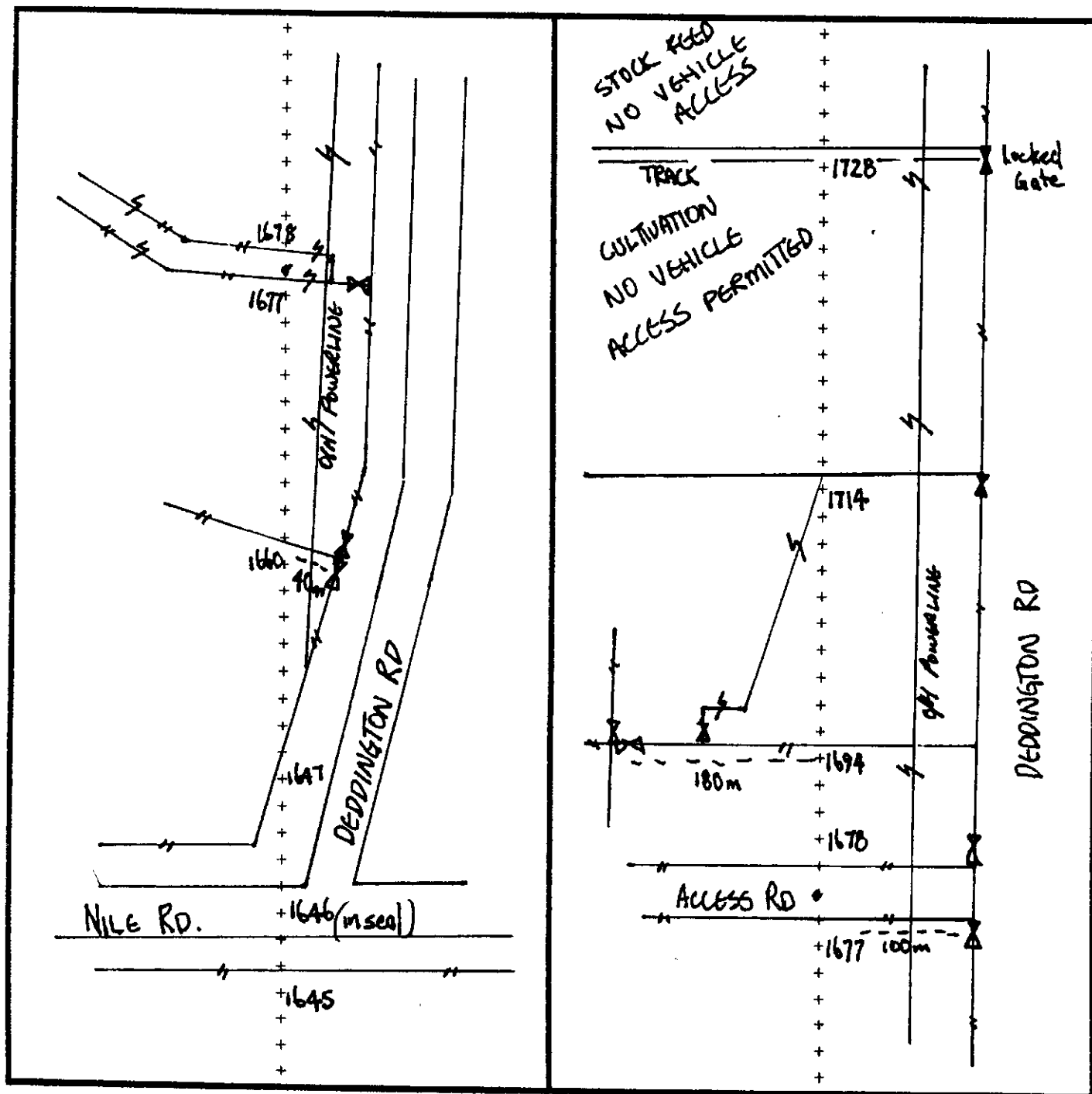

Wilson Survey Group P/L

Exploration, Mining and Engineering Surveyors  
Specialising in Real Time GPS Applications

Page.....of Pages.....

# Trace Diagram

Job No. 2001-003

Seismic Line PG

Client: Great South Lands Minerals Limited

Project: 2001 Northern Midlands Seismic Survey

Seismic Contractors: Trace Energy Services Pty. Ltd.

Stn Interval 25 m  
Shooting Direction

From STN 1736 To STN 1812  
West to East / ~~East to West~~

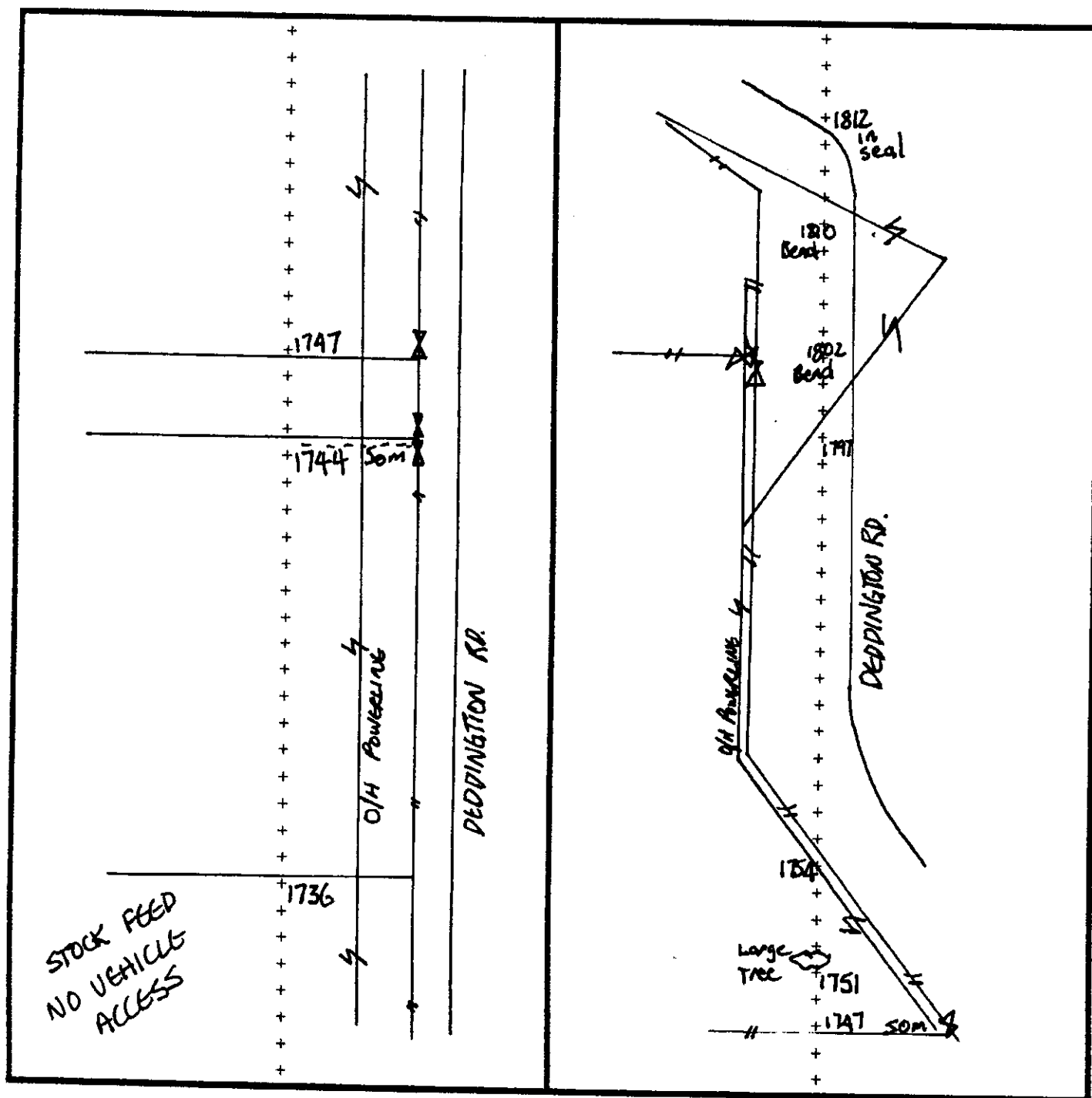

Wilson Survey Group P/L

Exploration, Mining and Engineering Surveyors  
Specialising in Real Time GPS Applications

Page.....of Pages.....

# Trace Diagram

Job No. 2001-003

Seismic Line PG

Client: Great South Lands Minerals Limited

Project: 2001 Northern Midlands Seismic Survey

Seismic Contractors: Trace Energy Services Pty. Ltd.

Stn Interval 25 m  
Shooting Direction

From STN 1813 To STN ~~1805~~ 1831  
West to East / South to North

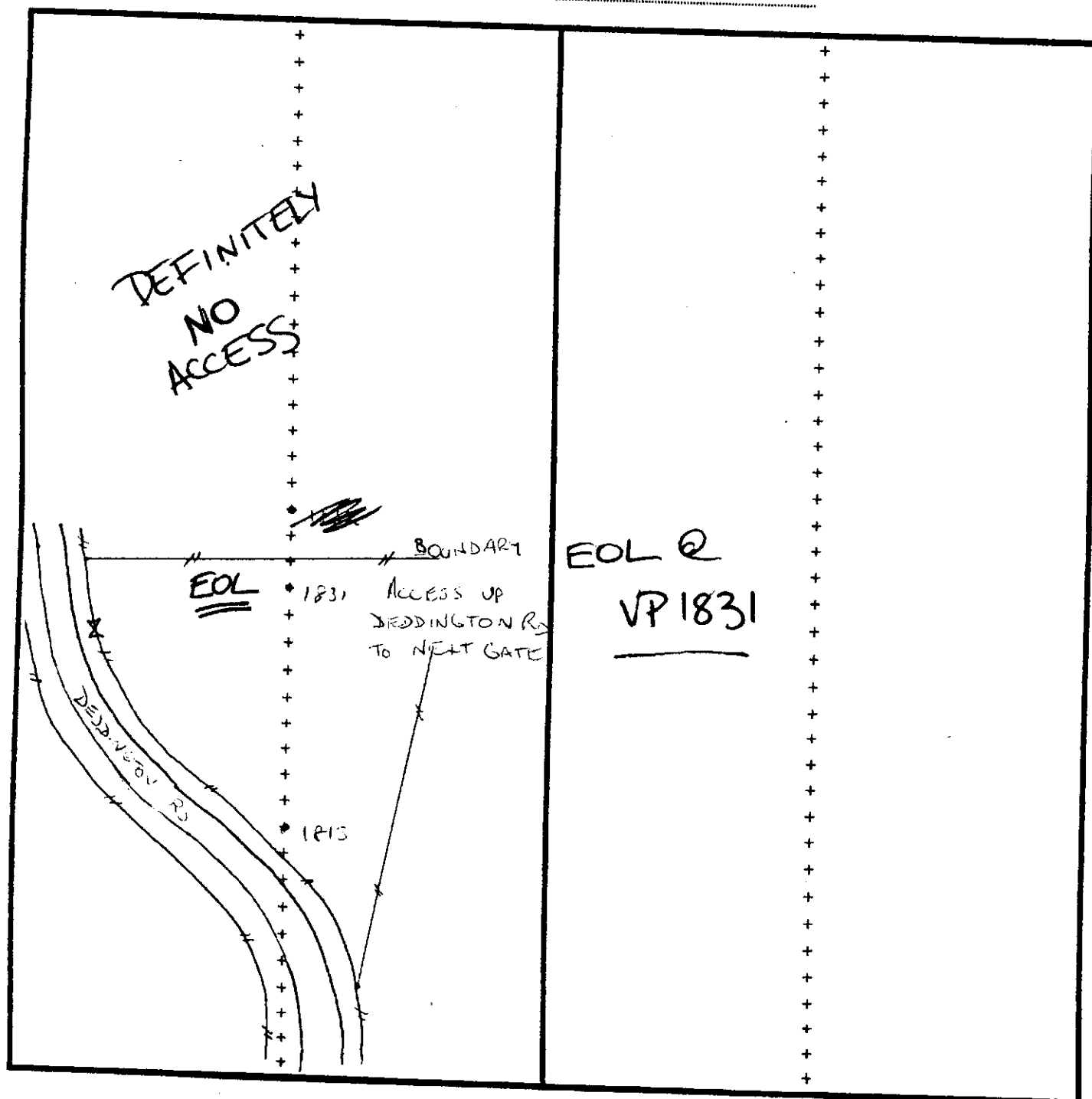

Wilson Survey Group P/L

Exploration, Mining and Engineering Surveyors  
Specialising in Real Time GPS Applications

Page.....of Pages.....

# Wilson Survey Group P/L

## Daily Productivity Report

Project : 2001 Midlands 2 D Seismic Survey

Client: Great South Lands Minerals Limited

Date: 07/03/2001      Job Number: 2001-003

### Ranging / Line Pointing

Surveyor		GPS Unit #		Survey Assistant		Vehicle Rego	
Hours		Start		Finish		Totals Hours	
Line Number		Starting Station	Ending Station	No. Stns	Distance	Comments	

### Chaining / Surveying Crew # 1

Surveyor		GPS Unit #		Survey Assistant		Vehicle Rego	
Hours		Start 0700		Finish 1900		Totals Hours	
Line Number		Starting Station	Ending Station	No. Stns	Distance	Comments	
PM		1139	1249	110	2.75	(Less 4.0Hrs Equipment Failure)	
						2.0Hrs Travel	
						3.0Hrs Extend Survey Control	
						1.0Hrs Detours	
						Many Fences without Gates	

### Chaining / Surveying Crew # 2

Surveyor		GPS Unit #		Survey Assistant		Vehicle Rego	
Hours		Start		Finish		Totals Hours	
Line Number		Starting Station	Ending Station	No. Stns	Distance	Comments	

# Wilson Survey Group P/L

## Daily Productivity Report

Project : 2001 Midlands 2 D Seismic Survey

Client: Great South Lands Minerals Limited

Date: 08 /03/2001      Job Number: 2001-003

### Ranging / Line Pointing

Surveyor		GPS Unit #		Survey Assistant		Vehicle Rego	
Hours		Start		Finish		Totals Hours	
Line Number		Starting Station	Ending Station	No. Stns	Distance	Comments	

### Chaining / Surveying Crew # 1

Surveyor		GPS Unit #		Survey Assistant		Vehicle Rego Toyota Dual Cab	
Hours		Start 0700		Finish 1900		Totals Hours	
		J Turner		P Hansen		12	
Line Number		Starting Station	Ending Station	No. Stns	Distance	Comments	
PM		726	754	28	0.7	2.0Hrs Travel	
PM		806	842	36	0.9	1.0Hrs Detour	
PI		413	713	300	7.5	Line slashed with gates	
					Total 9.1km	Time includes change from PM to PI	

### Chaining / Surveying Crew # 2

Surveyor		GPS Unit #		Survey Assistant		Vehicle Rego Hire Dual Cab	
Hours		Start 0700		Finish 1900		Totals Hours	
		R. Routley		A Worrall		12	
Line Number		Starting Station	Ending Station	No. Stns	Distance	Comments	
Bothwell		154	394	240	6.00Klm	Total Station Traverse	
						2.0Hrs Travel	



## Daily Productivity Report

**Client: Great South Lands Minerals Limited**

## Total Station Line Survey

**Surveyor** **R Routley**

**Totals Hours 12.0Hrs****Totals Hours 12.0Hrs**

# Chaining / Surveying Crew # 1

**J Turner**

**Totals Hours** 12

**Totals Hours** 12

**Totals Hours** 12

**Chaining / Surveying    Crew # 2**

**M Algar**

**Totals Hours 10.5**

**Totals Hours 10.5**

[illegible]

# Wilson Survey Group P/L

## Daily Productivity Report

Project : 2001 Midlands 2 D Seismic Survey

Client: Great South Lands Minerals Limited

Date: 10 /03/2001      Job Number: 2001-003

### Total Station Line Survey

Surveyor R Routley      GPS Unit # P Hansen  
Hours Start 0700      Finish 1800      Totals Hours 11.0Hrs      Vehicle Rego Hire Single Cab

Line Number	Starting Station	Ending Station	No. Stns	Distance	Comments
PB	618	762	144	3.6Klm	Travel 2.0Hrs Rain 2.0Hrs
PM	1128	1134	6	0.15Klm	Travel 2.0Hrs
PG	610	617	1	0.025Klm	Thick Gorse to River

### Chaining / Surveying Crew # 1

Surveyor J Turner      GPS Unit # Vehicle Rego Toyota Dual Cab  
Hours Start 0700      Finish 1800      Totals Hours 11.0Hrs  
Survey Assistant A Worrall (Nikki & Phil)

Line Number	Starting Station	Ending Station	No. Stns	Distance	Comments
PB	1104	1704	600	15.0Klm	2.0Hrs Travel Rain 1.5Hrs

### Chaining / Surveying Crew # 2

Surveyor M Algar      GPS Unit # Vehicle Rego Hire Dual Cab  
Hours Start 0930      Finish 1900      Totals Hours 9.5

Line Number	Starting Station	Ending Station	No. Stns	Distance	Comments
PB					Locate Existing Control For GPS Survey 2.0Hrs Travel Heavy Rain 2.0Hrs

**Wilson Survey Group P/L**

# Daily Productivity Report

**Project : 2001 Midlands 2 D Seismic Survey**

**Client: Great South Lands Minerals Limited**

**Date: 11/03/2001      Job Number: 2001-003**

## Total Station Line Survey

Surveyor  
R Routley

Hours	Start 0700
0700-0800	0700-0800
0800-0900	0800-0900
0900-1000	0900-1000
1000-1100	1000-1100
1100-1200	1100-1200
1200-1300	1200-1300
1300-1400	1300-1400
1400-1500	1400-1500
1500-1600	1500-1600
1600-1700	1600-1700
1700-1800	1700-1800
1800-1900	1800-1900
1900-2000	1900-2000
2000-2100	2000-2100
2100-2200	2100-2200
2200-2300	2200-2300
2300-2400	2300-2400

**GPS Unit #**

## Survey Assistant

## Totals Hours

**P Hansen**

11.5Hz

### Vehicle Rego Hire Single Cab

[illegible]

## Chaining / Surveying Crew # 1

**Surveyor**

## Hours

**J Turner**

# h 1630

GPS Unit #

## Survey Assistant

## Totals Hours

**Vehicle Rego Toyota Dual Cab**

[illegible]

## Chaining / Surveying Crew # 2

Surveyor

## Hours

**M Algar**

0800

GPS Unit #

## Survey Assistant

## Totals Hours

### Vehicle Rego Hire Dual Cab

Line Number	Starting Station	Ending Station	No. Stns	Distance	Comments
PB					Place Survey Control By GPS Every 5Kilom from Bothwell to Poatina Intersection & 5Kilom down Interlaken Road

Approved

# Daily Productivity Report

**Client: Great South Lands Minerals Limited**

## Survey Calculations

Hours	Start	Finish
0	08:00	08:00
1	08:00	09:00
2	09:00	10:00
3	10:00	11:00
4	11:00	12:00
5	12:00	13:00
6	13:00	14:00
7	14:00	15:00
8	15:00	16:00
9	16:00	17:00
10	17:00	18:00
11	18:00	19:00
12	19:00	20:00
13	20:00	21:00
14	21:00	22:00
15	22:00	23:00
16	23:00	00:00
17	00:00	01:00
18	01:00	02:00
19	02:00	03:00
20	03:00	04:00
21	04:00	05:00
22	05:00	06:00
23	06:00	07:00
24	07:00	08:00

### Survey Assistant

4.0Hrs

Chaining / Surveying Crew #1

Hours	Start 0700	Finish 1900
1	1	1
2	2	2
3	3	3
4	4	4
5	5	5
6	6	6
7	7	7
8	8	8
9	9	9
10	10	10
11	11	11
12	12	12
13	13	13
14	14	14
15	15	15
16	16	16
17	17	17
18	18	18
19	19	19
20	20	20
21	21	21
22	22	22
23	23	23
24	24	24

**Survey Assistant**

## A Worrall (Nikki & Phil)

Chaining / Surveying Crew # 2

Hours	Start 0700	Finish 1730
-------	------------	-------------

## Survey Assistant

**P. Hansen**

Line Number	Starting Station	Ending Station	No. Stns	Distance	Comments
PU	800	969	169	4.225Klm	Carry Thru Crops 858 to 870 & 952 to 969
					Travel 1.5Hrs
					Rain 1.0Hrs
					Detours 1.0Hrs